



**CENTURY 21.**  
Thompson Realty  
Cayman Islands  
**Amber Yates**  
Sales Agent/Consultant

Office: (345) 949-2100  
Office Fax: (345) 949-0610  
amber@c21cayman.com  
https://century21cayman.com

CENTURY 21 Thompson Realty Ltd., Grand Pavilion Commercial Centre, 802 West Bay Road, Grand Cayman, Cayman Islands KY1-1201

## OFF HUTLAND DRIVE, NORTHSIDE HOUSE LOT .23 ACRE

**CIREBA# 417526**

North Side (Grand Cayman) 📍 Cayman Islands

**MLS# 1154793**

Vacant Land

**75,000**

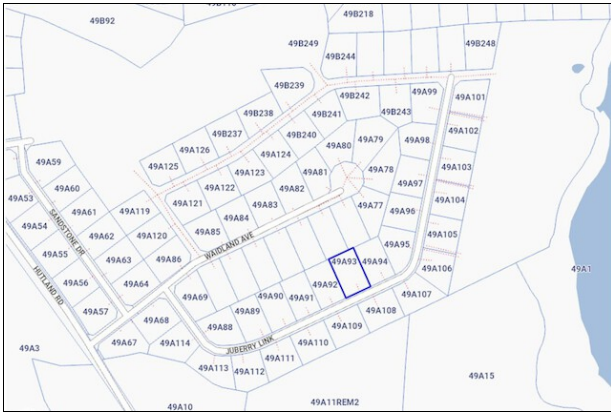

**CIREBA#:** 417526

**District/Area:** North Side (Grand Cayman)

**Region/Country:** Cayman Islands

**Available:** At Closing

**Prop.Type:** Vacant Land

**Prop.View:** Garden View

**Land Area:** 0.23 Acres

**Land Zoning:** Residential - Low Density

**Class:** Residential

### Features and Amenities

**Topography**

Flat

**Soil Type**

Marl

### Remarks

A cost effective, rectangular piece of land to build on, within the idyllic neighborhood of Hutland Drive in Northside. Photos by lands & survey.

### Directions

From Northside Road, turn into Hutland Drive., then turn left into Waidland Ave and then right into Juberry Link, House lot is on your left.